

*At the Court at Buckingham Palace*

THE 9th DAY OF JULY 2025

PRESENT,

THE KING'S MOST EXCELLENT MAJESTY  
IN COUNCIL

Representations were duly made to His Majesty in Council by the Secretary of State for Justice that, subject to the exceptions below, burials should be discontinued forthwith in:-

- 1) Christ Church Cemetery, Kintbury, Berkshire (as shown hatched on the plan annexed hereto);
- 2) Kenwyn Parish Church Churchyard, Truro, Cornwall (as shown hatched on the plan annexed hereto);
- 3) St Mary's Church Churchyard, Chigwell, Essex (as shown hatched on the plan annexed hereto);
- 4) St Mary's Churchyard, Ditchingham, Norfolk (as shown hatched on the plan annexed hereto);
- 5) St Nicholas Churchyard, Frankton, Rugby, Warwickshire (as shown hatched on the plan annexed hereto).

In pursuance of the Order in Council made on 6th May 2025 these representations have been published and taken into consideration by a Committee of the Privy Council.

Accordingly, His Majesty, in exercise of the powers conferred on Him by section 1 of the Burial Act 1853, is pleased, by and with the advice of His Privy Council, to order that burials shall be discontinued forthwith in the places listed above, subject to the following exceptions:-

- (a) in any vault or walled grave in the churchyard, burial may be allowed but every coffin in such vault or grave must be separately enclosed by stonework or brick work properly cemented;

- (b) in any existing earthen grave in the churchyard, the burial may be allowed of the body of any member of the family of the person or persons previously buried in that grave, but no part of the coffin containing the body shall be less than one metre below the level of the surface of the ground adjoining the grave; and
- (c) in any grave space in which no interment has previously taken place, the burial may be allowed of any person for whom, or any member of the family for which that grave space has been reserved and appropriated, with the exclusive right of burial there, but no part of the coffin containing the body shall be less than one metre below the level of the surface of the ground adjoining the grave.

*Richard Tilbrook, CVO*

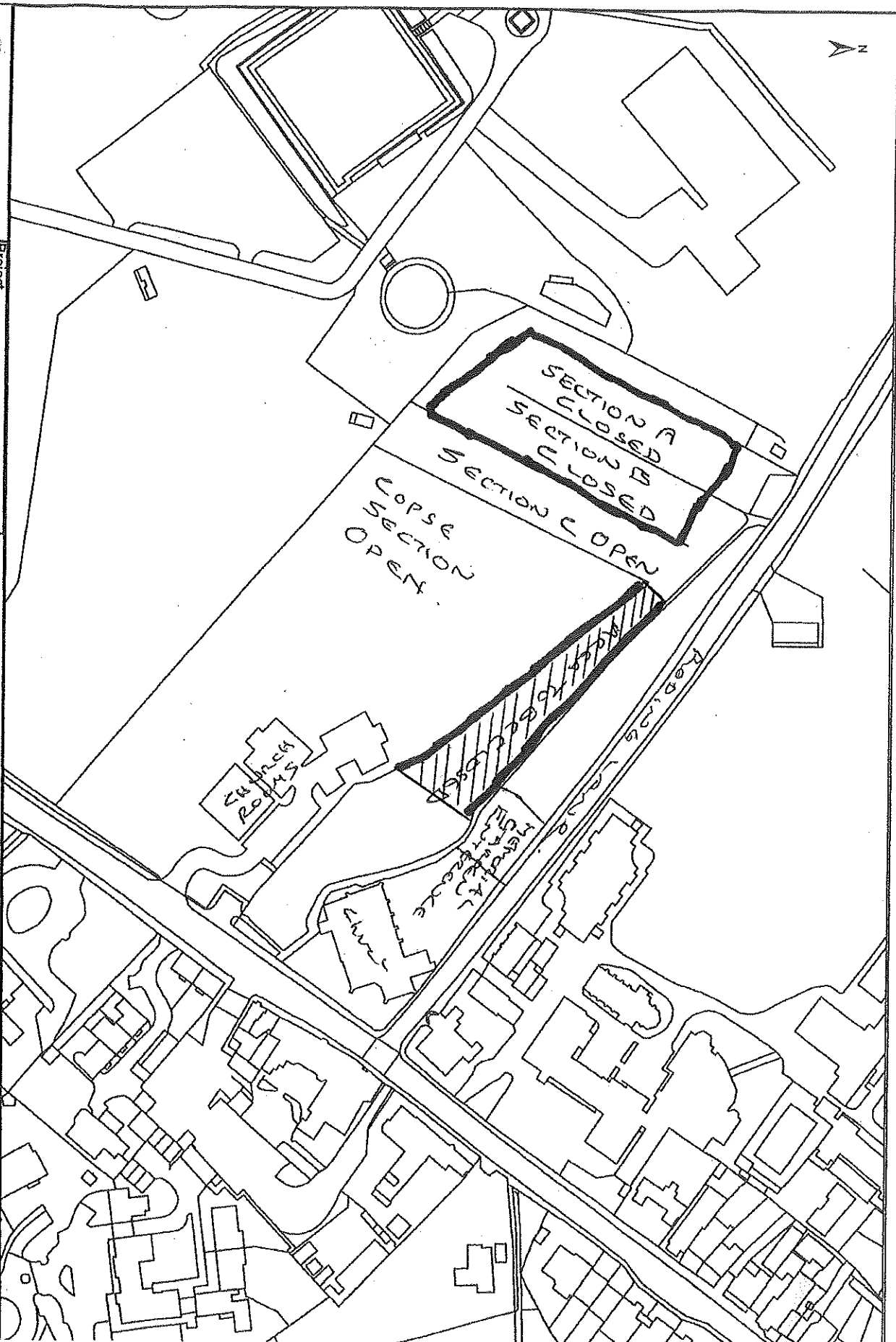

 <p><b>Epping Forest District Council</b></p>	<p><b>Project</b></p> <p>Drawing No. MW239</p>	<p><b>Content:</b></p> <p>Saint Mary The Virgin Church High Road Chigwell IG7 6QD</p>	<p><b>Date:</b> 12/04/2024</p> <p><b>Scale:</b> 1:1000@A3</p> <p><b>Name:</b> mwilliams</p> <p><small>Contains Ordnance Survey &amp; Royal Mail Data © Crown Copyright &amp; Ordnance Survey 2020 © Royal Mail Copyright &amp; Ordnance Survey 2020 © National Geographic &amp; National Geographic Reproduced with the permission of National En</small></p>
---	--	---	---